



## RATINGS AND CHARACTERISTICS CURVES (TA = 25 °C unless otherwise noted)

Fig.1: Current Derating Curve

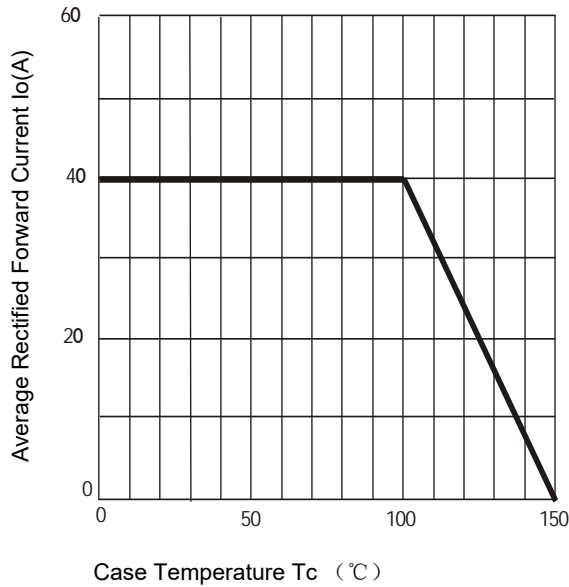

Fig.2 Typical Reverse Characteristics

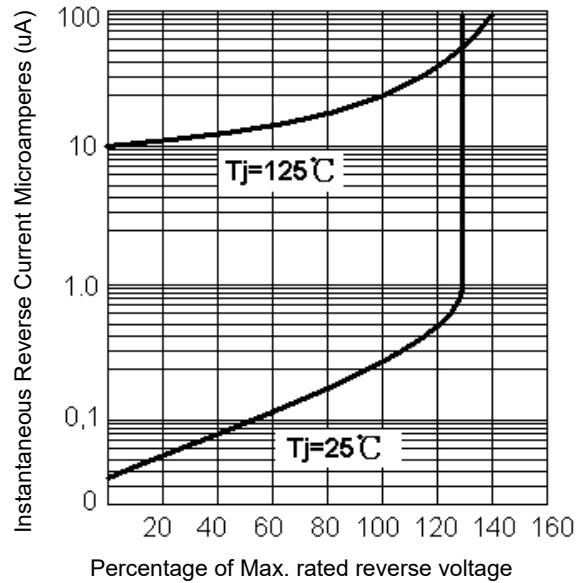

Fig.3: Max. Surge Current

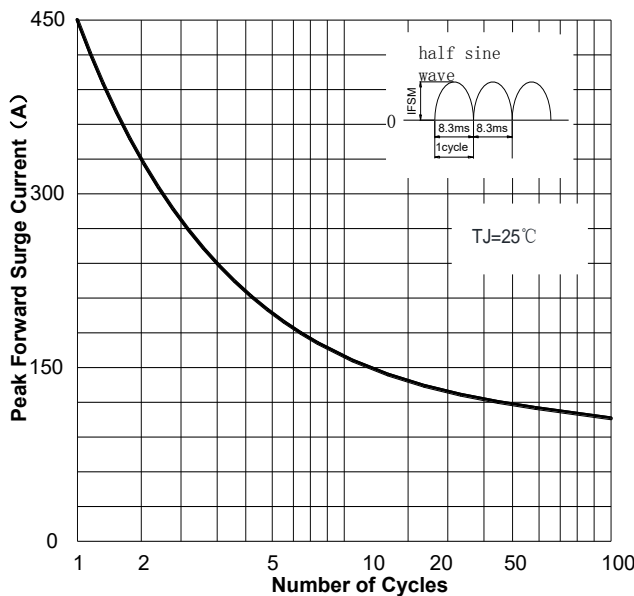
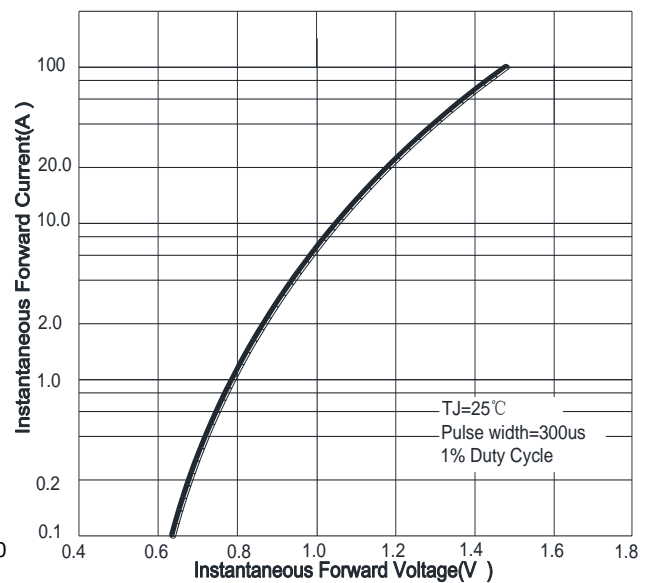
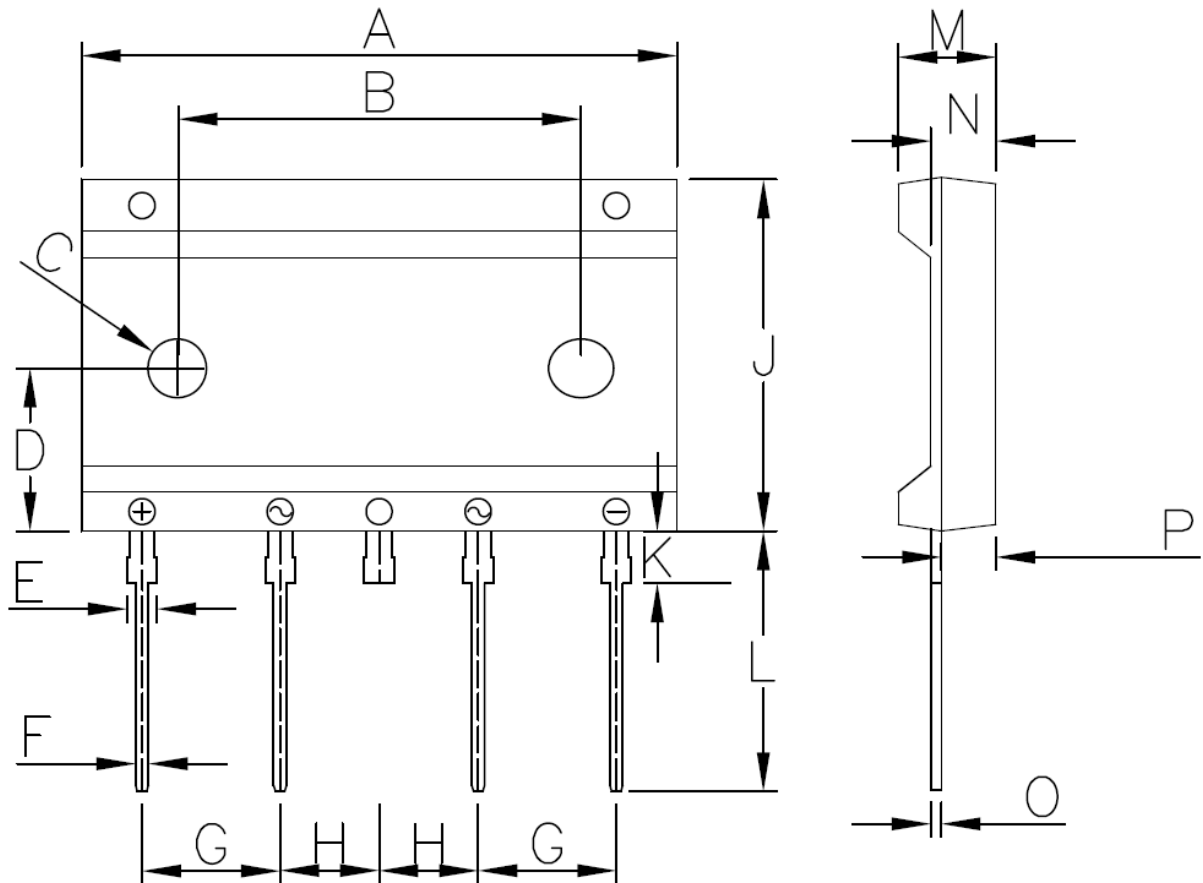

Fig.4: Rated Forward Features



## PACKAGE OUTLINE DIMENSIONS

Note:unit mm(inch)



DXB mechanical data: unit mm(inch)

	A	B	C	D	E	F	G	H	J	K	L	M	N	O	P
max	46.1	31.1	4.8	12.8	2.5	1.3	10.9	8.0	27.5	4.2	20.5	8.4	5.9	1.0	4.8
min	45.3	30.9	4.4	12.2	2.1	0.7	10.3	7.2	26.5	3.8	19.5	7.6	5.1	0.6	4.2
max	1.81	1.22	0.19	0.51	1.3	0.10	0.43	0.32	1.09	0.17	0.81	0.33	0.24	0.04	0.19
min	1.78	1.21	0.17	0.48	1.0	0.02	0.40	0.28	1.04	0.15	0.76	0.29	0.20	0.5	0.16